



Modular Buildings | Mobile Offices | Storage Solutions

## 8 x 32 Office/Storage

### \*Features include:

- Steel security door
- Vinyl-sided gypsum walls
- Vinyl windows
- Rubber roof with R-19 insulation
- Approx. 128 sq. ft. of storage space

\*On 2005 models and newer

\*Door, window, and partition locations may vary depending on manufacturer

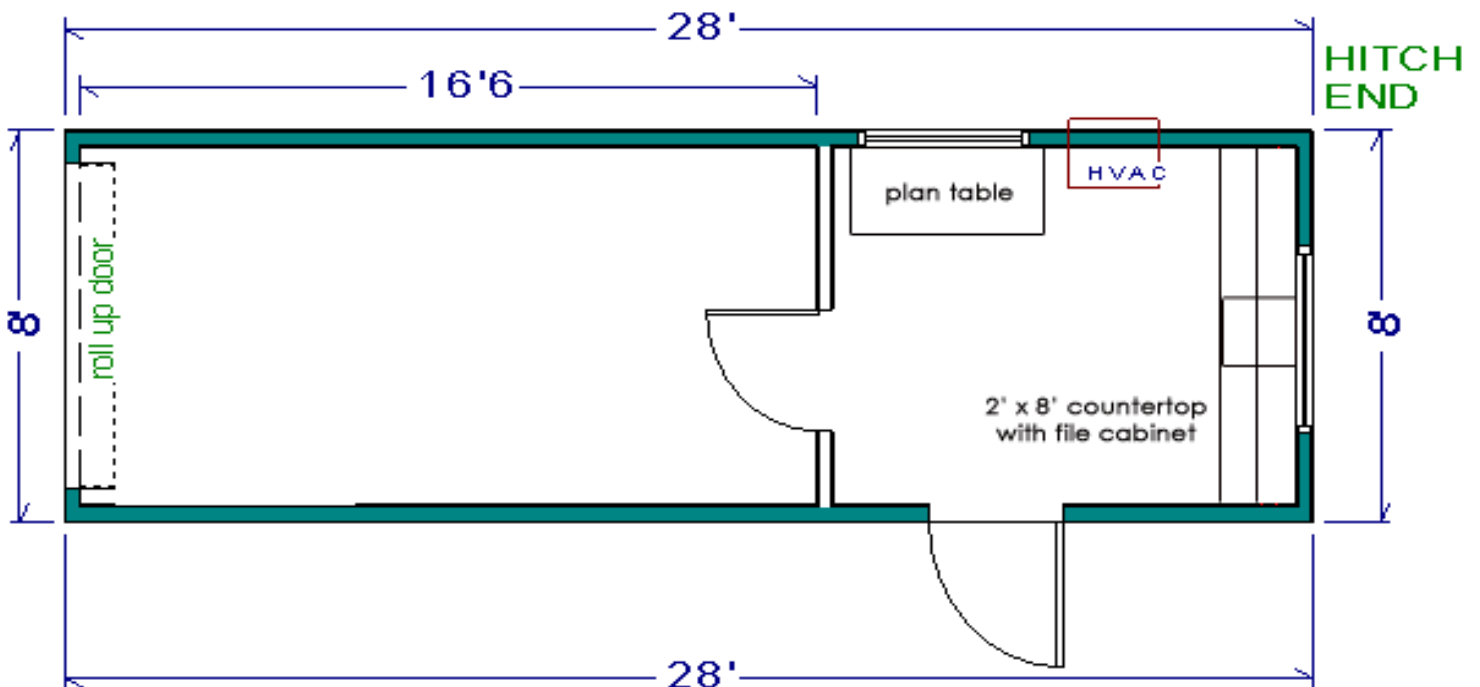
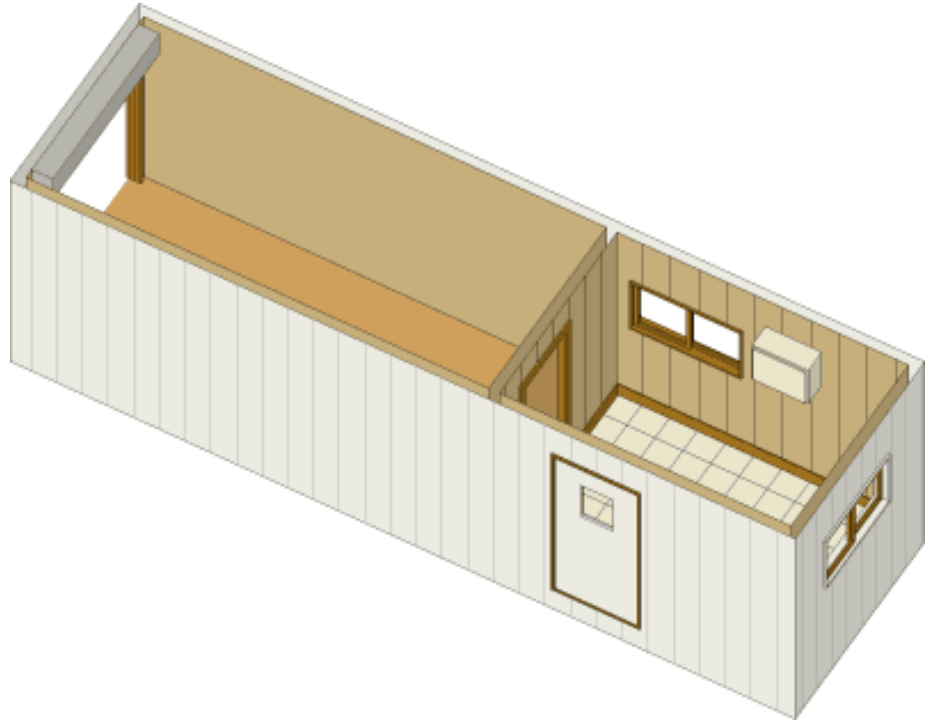

800-257-2536 [www.triumphmodular.com](http://www.triumphmodular.com)