



TRIUMPH

M O D U L A R

A T E C N O F A S T C O M P A N Y[®]

Rental Division

QUALITY SOLUTIONS



MOBILE OFFICE FLEET



TEMPORARY SOLUTIONS



Rental Division

Triumph Modular over 40-years of experience leasing and providing space solutions across a variety of industries.

What are the features of the mobile offices?

Our fleet features a sleek grey color scheme with wood exterior siding and HVAC systems. Our interiors have all been standardized to include motion sensor light switches, USB ports, and energy-efficient windows.

Which States do we service and deliver to?

Triumph Modular's Boston Headquarters services Massachusetts, New Hampshire, Connecticut, and Rhode Island. Our Northern New England branch services Maine, Vermont, and New Hampshire. The Pittsburgh Region branch services western Pennsylvania, Ohio, and West Virginia. The Philadelphia Region branch services eastern Pennsylvania, New Jersey, and Delaware. Our Detroit branch services Michigan.

What are the different mobile office options?

We offer mobile office trailers ranging from 8' x 24' to 12' x 64'. For larger space requirements, we offer double-wide modular buildings, 24' x 64', and modular complexes that can be built to suit any desired office space.

What are the benefits of a mobile office?

Mobile offices offer several benefits, making them an excellent choice for temporary or flexible workspaces. These portable units can be delivered and set up quickly for both short-term and long-term use. They provide versatility in customization, allowing the addition of steps, ramps, and a variety of office furniture to ensure a comfortable and efficient workspace. Office containers provide a durable and safe solution for job sites requiring secure ground-level access. Additionally, mobile offices are ideal for construction sites, events, or remote locations where traditional office setups may not be feasible. Their adaptability and convenience make them a practical option for various industries.

COMPARE MOBILE OFFICE OPTIONS

| Width & Length | Office Square Feet | Private Offices | Bathroom | Heating/Cooling |
|---------------------------------|--------------------|-------------------|----------|-------------------------|
| 8' x 24' OFFICE TRAILER | 192 | NONE | NONE | 10,000 BTU Thru Wall |
| 8' x 32' OFFICE TRAILER | 224 | 1 PRIVATE OFFICE | OPTIONAL | 1-Ton Wall-Mounted Bard |
| 10' x 36' OFFICE TRAILER | 320 | 1 PRIVATE OFFICE | OPTIONAL | 1-Ton Wall-Mounted Bard |
| 10' x 44' OFFICE TRAILER | 400 | 1 PRIVATE OFFICE | YES | 2-Ton Wall-Mounted Bard |
| 10' x 50' OFFICE TRAILER | 460 | 2 PRIVATE OFFICES | OPTIONAL | 2-Ton Wall-Mounted Bard |
| 12' x 60' OFFICE TRAILER | 672 | 2 PRIVATE OFFICES | OPTIONAL | 3-Ton Wall-Mounted Bard |
| 12' x 64' OFFICE TRAILER | 720 | 2 PRIVATE OFFICES | YES | 3-Ton Wall-Mounted Bard |
| 8' x 20' CONTAINER OFFICE | 160 | NONE | NONE | 8,000 BTU Thru Wall |
| 8' x 40' CONTAINER OFFICE | 320 | NONE | NONE | 8,000 BTU Thru Wall |
| 8' x 40' COMBO OFFICE & STORAGE | 128 | NONE | NONE | 8,000 BTU Thru Wall |

MOBILE OFFICES

Sample of Our Fleet



8' x 24'



10' x 44'



12' x 64'



8' x 40'

BLOCSTM Clear Span Modular Building System

Triumph Modular's BLOCS system takes your project from concept to completion, with a limitless open concept.

Two restrooms
and storage closet

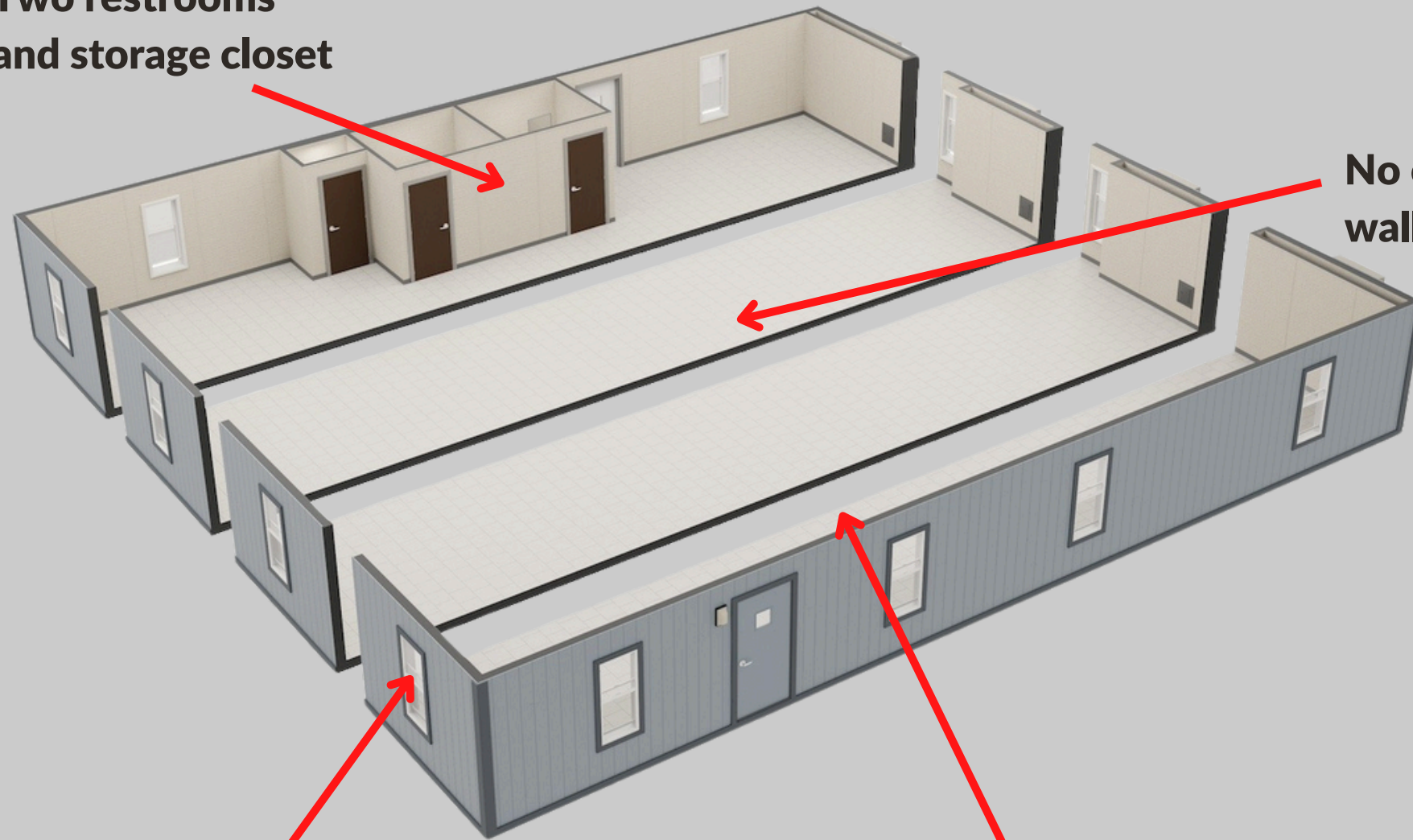

No columns or supporting
walls are required.

Customize the interior
with our BLOCSTM Walls

Less bounce in the
building due to the use
of a perimeter frame.

Fast and flexible to
accommodate all sizes
and configurations



THE SOLUTIONS

Triumph Modular provides furniture and accessory solutions for your mobile office, enabling immediate move-in capabilities. Our goal is to help you quickly and conveniently set up your office.

Express Bistro Solution



Express Workstation Solution



Business Office Solution



Business Breakroom Solution



Business Conference Solution



THE SOLUTIONS

Planning Solution



Reception Solution



Business Entry Solution



Data Solution

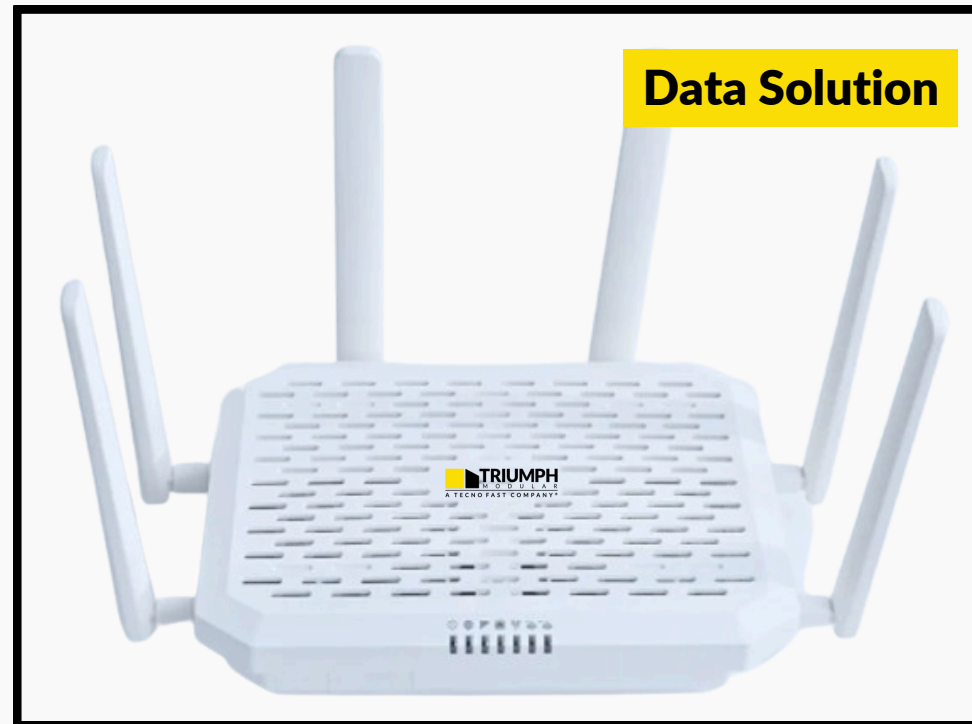

Security Entrance Solution



BLOCSTM Walls



Features and Benefits



8-foot-tall Modular Walls



Installed using a track system

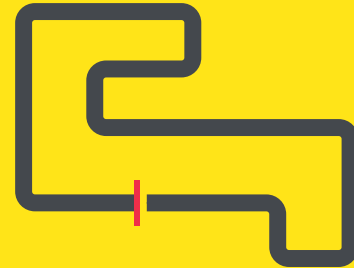

Flexible configurations to assist with desired layouts



Electrical raceways between wall panels



Contact Us

QUESTIONS?

1-800-257-2536

www.TriumphModular.com

INNOVATION



QUALITY



EXPERIENCE